

# ACTviquest+

ACTviquest+ is an integrated video management and access control solution using advanced state of the art optimized hardware and ACTenterprise software (pre-installed). Available as both desktop or 19" rack mountable versions, the ACTviquest+ is capable of recording up to 16 channels and managing your complete access control solution.

With a 16TB hard drive, the ACTviquest+ will suit most small to medium sized applications. ACTviquest+ allows approximately 25 days of 1080p, 25fps, 24hr recording.

## Main Features

- ▶ Desktop or 19" Rack Mountable
- ▶ Up to 16CH recording and unlimited Live View with ACT Enterprise Pro.
- ▶ High performance optimisation with hardware decoding
- ▶ Mobile App - ACTviquest<sup>mobile</sup>
- ▶ Optimised Windows OS
- ▶ Smart Archive Search
- ▶ Sync and Async Playback
- ▶ Dual Monitor Support
- ▶ Live View, Full HD in real time
- ▶ Integrated Event Manager
- ▶ Built-in Web Browser
- ▶ Built-in Camera Discovery Wizard
- ▶ ONVIF

If you require more than 16 channels, multiple ACTviquests can be easily used together with seamless integration into one dashboard.



# ACT

## Integrated Access Control and Video Management Solutions



ACTviquest+ diagram showing a possible layout:

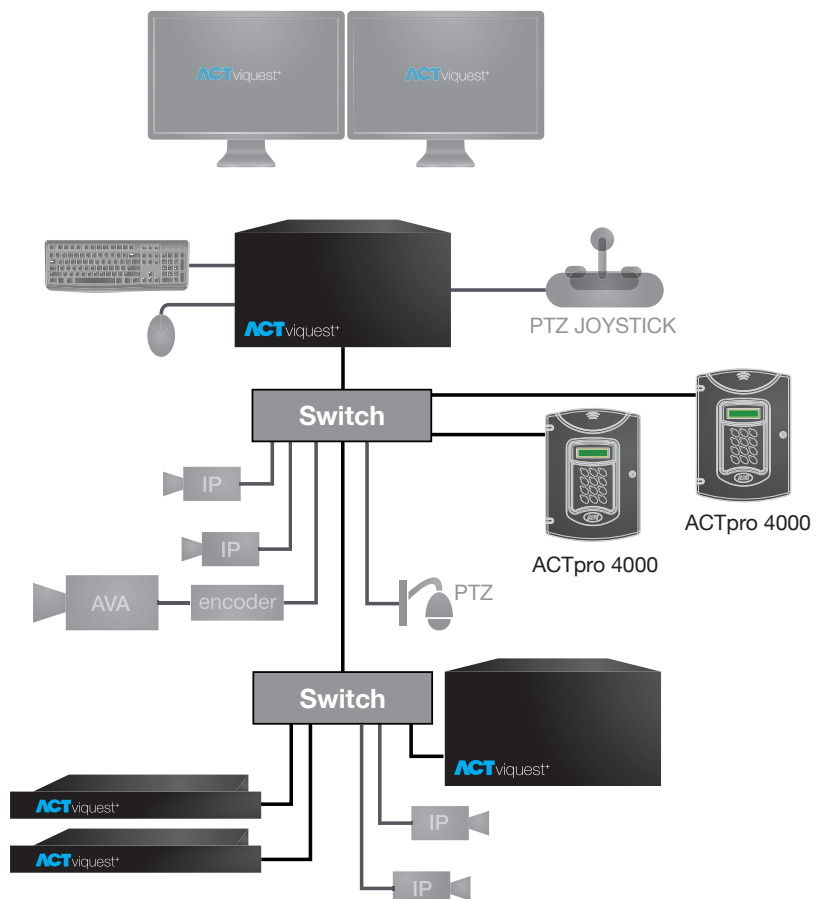

## Specifications

|                                |   |
|--------------------------------|---|
| <b>ACTviquest</b>              | 16CH NVR with integrated VMS & Access Control available in Desktop or 19" Rack mountable.                                     |
| <b>Supported Cameras</b>       | Major manufacturers supported   |
| <b>OS</b>                      | MS Win7 Embedded X64  |
| <b>Image format</b>            | H264, MPEG4, MJPEG  |
| <b>Audio Format</b>            | Supported dependent on camera device  |
| <b>Display</b>                 | Up to 16 way split per monitor; view within view  |
| <b>Live and Playback</b>       | Simultaneous views of live and archived footage, up to 16 way on replay, 16 Concurrent Live video feeds                       |
| <b>Digital Zoom</b>            | Digital Zoom on Live & Playback with thumbnail preview  |
| <b>Recording</b>               | Motion, Scheduled, Analytics, IO, Loop  |
| <b>Pre / Post Alarm</b>        | Minimum 5 seconds Pre and Post alarm  |
| <b>Playback Controls</b>       | Play, Stop, Timeline high speed navigation, Go To, FF, RW, Synchronous Control, Up to 32X. Frame by Frame Forward and Reverse |
| <b>Export</b>                  | MPEG, AVI, Native with embedded mini player   |
| <b>External Media</b>          | Supported via USB   |
| <b>Snapshot</b>                | YES   |
| <b>PTZ Control</b>             | Full PTZ support  |
| <b>Keyboard Control</b>        | Keyboard and mouse control with configurable keypad presets   |
| <b>Joystick Control</b>        | Full joystick support includes jog wheel, buttons and proportional input  |
| <b>Recording Duration</b>      | Approx 25 days at 25fps, 24/7, 1080p (60Mbit/s)   |
| <b>HDD</b>                     | 16TB CCTV Optimised Dedicated Drive. 4 x 4TB  |
| <b>Throughput</b>              | 240Mbit/sec   |
| <b>Remote Access</b>           | Web browser allowing Live and Playback. Mobile client for Live / Replay & Control.  |
| <b>Alarm Inputs</b>            | Interface to Adams IO   |
| <b>Network</b>                 | 2 x Gig Ethernet  |
| <b>Peripheral Connectivity</b> | 2 x USB3, 2 x USB2, 2 x USB Front, 2 x Gig Ethernet, SPK out, MIC in, DVI-D ,VGA, Power                                       |
| <b>Power</b>                   | 230VAC (input), 19V - 5.5AMP  |
| <b>Monitor Support</b>         | Dual monitor supported via DVI-D, VGA   |
| <b>Dimensions (DxWxH)</b>      | Desktop 311mm x 230mm x 129mm, Rack Mount 385mm x 425mm x 45mm  |
| <b>Weight</b>                  | 6kg   |
| <b>Operating Temperatures</b>  | 0 - 55 degC   |

For larger Industrial or facility requirements, have a look at ...

# ACTviquest<sup>PRO</sup>



Unlimited Video Management Software - Fully integrated with ACTenterprise Software.